

Dimensions = mm

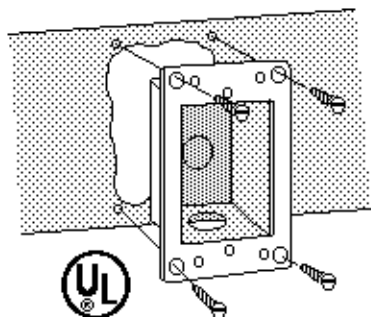

UL 514A

1-GANG

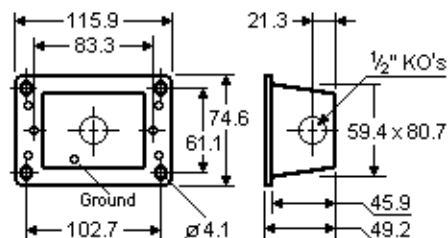

- Heavy duty cast aluminum construction.
- Thermoset protective silver grey finish.
- For use as recessed, flush mount box.
- Supplied with 1/2" conduit knockouts.

Hohlwand-Spezialdose, geeignet zum Einbau in Kabelkanäle und Schaltschränke (Berührungsschutz), drei 1/2" Kabelzuführungen, Aluminium-Guss

Catalog Number	Beschreibung	Description	Weight/ea	EDP No	UPE/Packed
TF 11	Hohlwand-Spezialdose	Special Flanged Outlet Box	142g	103535	100/10

Recessed die cast aluminum box with flange for quick and easy flush mounting.

This UL-Listed flanged box mounts anywhere on an outside building wall. Box has three 1/2" knockout (KO's) holes (one each end, one in back).

There's no need to locate a vertical stud as with standard boxes. Just cut an appropriate hole, apply caulking compound to the underside of the flange, screw on the quick-mount box, and that's it! Provides a perfect weatherproof seal between the flange and whatever receptacle cover is employed.