

## Switzerland

### Adaptor Plugs for Fixed Connection, 10 Amp, 2P + E

Adaptor plug for the permanent connection of a mains plug suitable for a grounding pin (CEE7/7). The adaptor for outdoor usage (IPX4) requires a mains plug rated IP44 to seal the connection.



Construction tested by  
**electrosuisse**

#### SPECIFICATIONS

- Adaptor plug for fixed connection (not again removable)
- Construction tested by ElectroSuisse
- **Only for devices up to 10 Ampere !**
- Degree of Protection: IP20 (Indoor Usage), IPX4 (Outdoor Usage)
- 2-Pole 3-Wire grounded (2P + E)
- Rated current: 10 Amp max, Rated voltage: 250 Volt AC max
- Standards according: DIN 49441 Part 1, SEV 6534-2, CEE 7
- Material of terminals: CuZn 37 , CuZn 39 , Fe
- Housing and Carrying Parts: Polyamide 6
- Single packing in polybag with mounting instructions printed on.



153BKN shown

**NOTE: If a mains plug plugged once, the connection can not be removed again without destruction of the adaptor parts!**

#### ORDERING INFORMATION

Catalog No.	Color	Description	EDP No.
<b>153BKN</b>	Black	Adaptor plug for fixed connection SEV Type 12, 2P + E, 10A/250V, indoor usage (IP20)	127408
<b>153WHN</b>	White	Adaptor plug for fixed connection SEV Type 12, 2P + E, 10A/250V, indoor usage (IP20)	127417
<b>153BKNX4</b>	Black	Adaptor plug for fixed connection SEV Type 12, 2P + E, 10A/250V, outdoor usage (IPX4)	127983

#### NOMINAL DIMENSIONS: mm

153WHN shown

with partial insulated pins (phase and neutral) as mandatory in Switzerland since January, 1st 2013

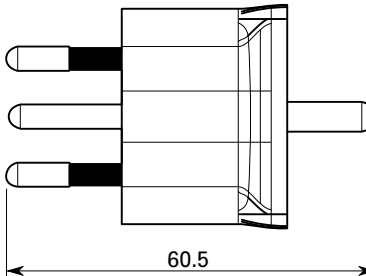
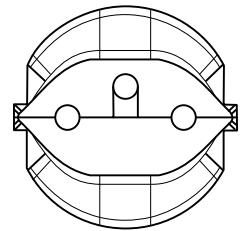
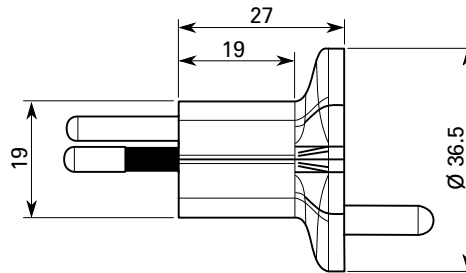
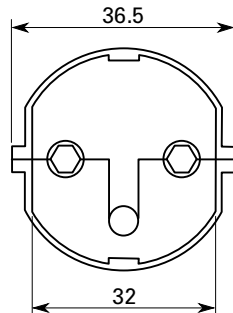

Products that are delivered to Switzerland with these adaptors must bear the following marking:

*Produkte, welche mit diesen Adaptern in die Schweiz geliefert werden, müssen nachfolgende Kennzeichnung tragen:*

**Betrieb in der Schweiz mit Übergangsstecker Nr. 153 nur für Erzeugnisse bis max. 10 A zulässig.**



Shipped with assembly tool and mounting instructions for each Adapter.

#### Parts included with the standard version for indoor usage (IP20)

#### Additional parts included with the outdoor version (IPX4)



One-Time Plug Adaptor  
153 Series



Mains plug press-in tool  
(Mounting Tool)

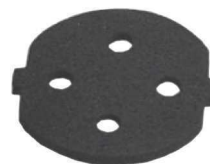

Gasket (P/N 802)  
The gasket is placed between the power plug and adaptor.



Protective boot (P/N 803)  
The protective boot is slid onto adaptor and power plug (IP44) to seal the connection.

## Switzerland

### Adaptor Plugs for Fixed Connection, 10 Amp, 2POL

Adaptor plug for the permanent connection of a 2-Pole Contour Plug (CEE 7/17). The adaptor for outdoor usage (IPX4) requires a mains plug rated IP44 to seal the connection.



Construction tested by  
**electrosuisse** >>

#### SPECIFICATIONS

- Adaptor plug for fixed connection (not again removable)
- Construction tested by ElectroSuisse
- **Only for devices up to 10 Ampere !**
- Degree of Protection: IP20 (Indoor Usage), IPX4 (Outdoor Usage)
- 2-Pole 2-Wire NON-Grounding (2POL)
- Rated current: 10 Amp max, Rated voltage: 250 Volt AC max
- Standards according: DIN 49406 Part 1, SEV 416533-2
- Material of terminals: CuZn 39, Fe
- Housing and Carrying Parts: Polyamide 6
- Single packing in polybag with mounting instructions printed on.



154BKNX4 shown

**NOTE: If a mains plug plugged once, the connection can not be removed again without destruction of the adaptor parts!**

#### ORDERING INFORMATION

Catalog No.	Color	Description	EDP No.
<b>154BKN</b>	Black	Adaptor plug for fixed connection SEV Type 11, 2POL, 10A/250V, indoor usage (IP20)	127416
<b>154WHN</b>	White	Adaptor plug for fixed connection SEV Type 11, 2POL, 10A/250V, indoor usage (IP20)	127418
<b>154BKNX4</b>	Black	Adaptor plug for fixed connection SEV Type 11, 2POL, 10A/250V, outdoor usage (IPX4)	127985

#### NOMINAL DIMENSIONS: mm

154WHN shown

with partial insulated pins (phase and neutral) as mandatory in Switzerland since January, 1st 2013

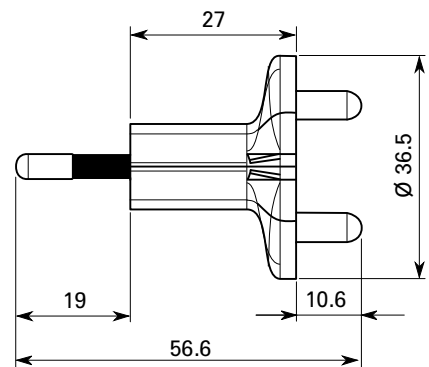
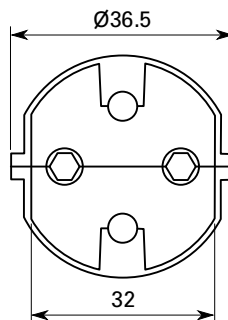

Products that are delivered to Switzerland with these adaptors must bear the following marking:

Produkte, welche mit diesen Adaptern in die Schweiz geliefert werden, müssen nachfolgende Kennzeichnung tragen:

**Betrieb in der Schweiz mit Übergangsstecker Nr. 154 nur für Erzeugnisse bis max. 10 A zulässig.**



Shipped with assembly tool and mounting instructions for each Adapter.

#### Parts included with the standard version for indoor usage (IP20)

#### Additional parts included with the outdoor version (IPX4)



One-Time Plug Adaptor  
154 Series



Mains plug press-in tool  
(Mounting Tool)

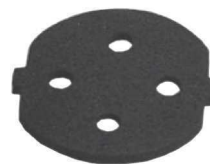

Gasket (P/N 802)  
The gasket is placed between the power plug and adaptor.



Protective boot (P/N 804)  
The protective boot is slid onto adaptor and power plug (IP44) to seal the connection.

## Switzerland

### Adaptor Plugs for Fixed Connection, 16 Amp, 2P + E

Adaptor plug for the permanent connection of a mains plug suitable for a grounding pin (CEE7/7). The adaptor for outdoor usage (IPX4) requires a mains plug rated IP44 to seal the connection.



Construction tested by  
**electrosuisse**

#### SPECIFICATIONS

- Adaptor plug for fixed connection (not again removable)
- Construction tested by ElectroSuisse
- **Only for devices up to 16 Ampere !**
- Degree of Protection: IP20 (Indoor Usage), IPX4 (Outdoor Usage)
- 2-Pole 3-Wire grounded (2P + E)
- Rated current: 16 Amp max, Rated voltage: 250 Volt AC max
- Standards according: DIN 49441 Part 1, SEV 5934-2, CEE 7
- Material of terminals: CuZn 37, CuZn 39, Fe
- Housing and Carrying Parts: Polyamide 6
- Single packing in polybag with mounting instructions printed on.



163WH shown

**NOTE: If a mains plug plugged once, the connection can not be removed again without destruction of the adaptor parts!**

#### ORDERING INFORMATION

Catalog No.	Color	Description	EDP No.
<b>163BK</b>	Black	Adaptor plug for fixed connection SEV Type 23, 2P + E, 16A/250V, indoor usage (IP20)	123367
<b>163WH</b>	White	Adaptor plug for fixed connection SEV Type 23, 2P + E, 16A/250V, indoor usage (IP20)	123368
<b>163BKX4</b>	Black	Adaptor plug for fixed connection SEV Type 23, 2P + E, 16A/250V, outdoor usage (IPX4)	127984

#### NOMINAL DIMENSIONS: mm

163WH shown

adaptors with partially insulated contact pins (L + N) are required only for Type 11 and Type 12 and NOT for SEV Type 23.

Products that are delivered to Switzerland with these adaptors must bear the following marking:

Produkte, welche mit diesen Adaptern in die Schweiz geliefert werden, müssen nachfolgende Kennzeichnung tragen:

**Betrieb in der Schweiz mit Übergangsstecker Nr. 163 nur für Erzeugnisse bis max. 16 A zulässig.**

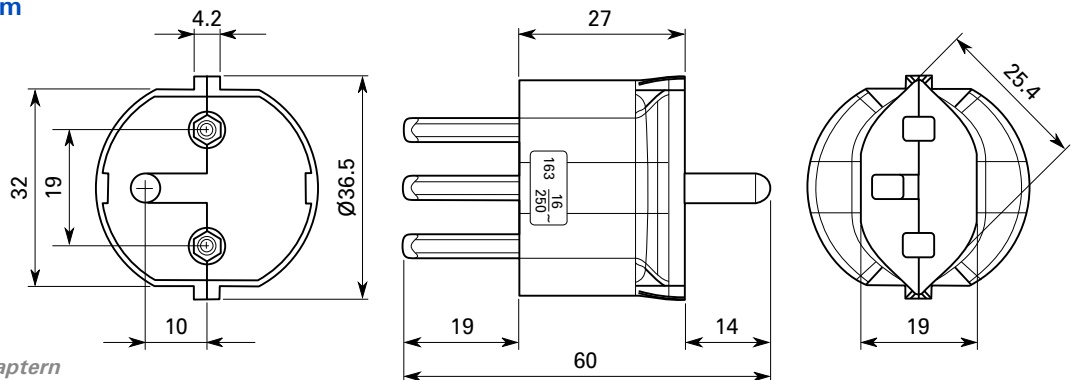

Shipped with assembly tool and mounting instructions for each Adapter.

#### Parts included with the standard version for indoor usage (IP20)

#### Additional parts included with the outdoor version (IPX4)



One-Time Plug Adaptor  
163 Series



Mains plug press-in tool  
(Mounting Tool)

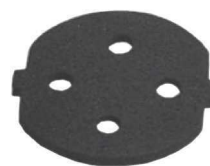

Gasket (P/N 802)  
The gasket is placed between the power plug and adaptor.



Protective boot (P/N 803)  
The protective boot is slid onto adaptor and power plug (IP44) to seal the connection.

## (EN) Mounting instructions

## (DE) Montageanleitung

## (FR) Instructions de montage

## (IT) Istruzioni per il montaggio

– The instruction shows the mounting of the adapter 153BKNX4, with a mains plug IP44

– Die Anleitung zeigt die Montage des Adapters 153BKNX4, mit einem Netzstecker IP44

– L'instruction montre le montage de la adaptateur 153BKNX4 avec une fiche d'alimentation IP44

– L'istruzione mostra il montaggio del adattatore 153BKNX4, con spina di alimentazione IP44

– Disposable mounting for a single permanent and solid connection. Without destruction no longer solvable!

– Einwegmontage, zur einmaligen und festen Verbindung. Ohne Zerstörung nicht mehr lösbar!

– Montage unique pour raccordement fixe. Ne peut plus se détacher sans destruction!

– Adattatore mono-uso per applicazione fissa. Una volta assemblato non è più possibile rimuoverlo senza distruggerlo!

Adaptor CEE7-SEV type 12 shown with mains plug press-in tool



Adaptor with protective boot and gasket

Übergangsstück mit Glocke und Dichtung

Adaptateur avec cloche de protection et joint

Adattatore con protezione involucro e la guarnizione

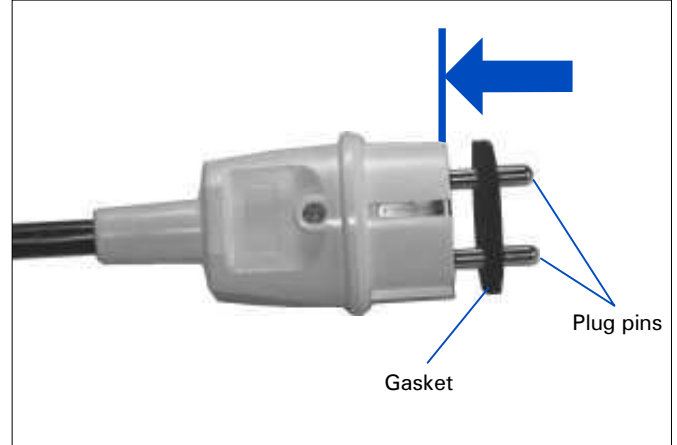

1. Slide the gasket onto the plug pins

1. Schieben Sie die Dichtung auf die Steckerstifte

1. Poussez le joint contre la butée au contact mâle

1. Spingete la guarnizione sopra gli spinotti

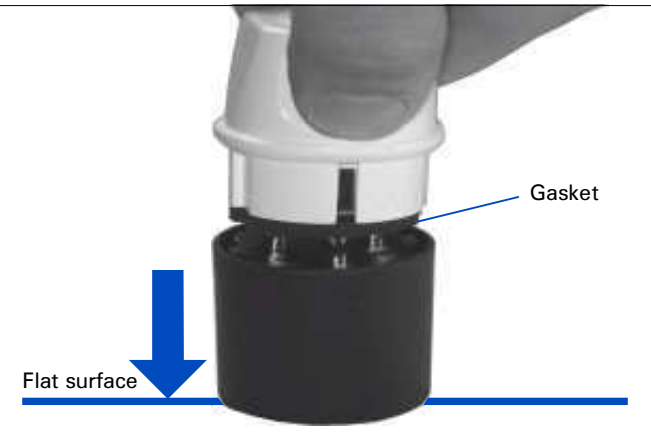

2. Place the adaptor on a flat surface

2. Stellen Sie den Adapter auf eine ebene Fläche

2. Posez l'adaptateur sur une surface plane

2. Posate l'adattatore su una superficie piana

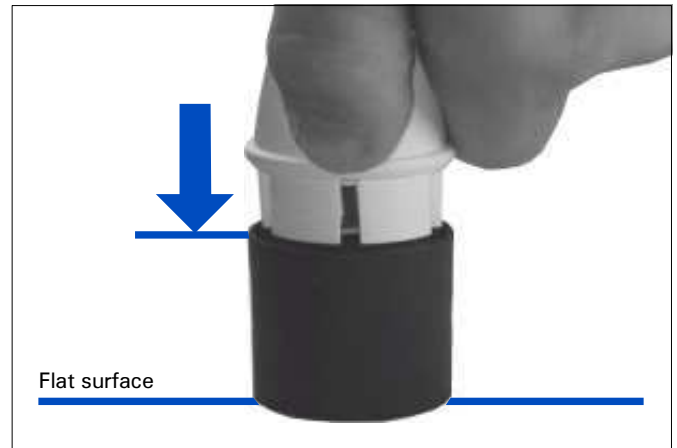

3. Press the mains plug flush into the adaptor socket

3. Drücken Sie den Netzstecker bündig in die Adapterbuchse

3. Enfoncez la fiche entièrement dans l'adaptateur

3. Spingete la guarnizione sopra gli spinotti

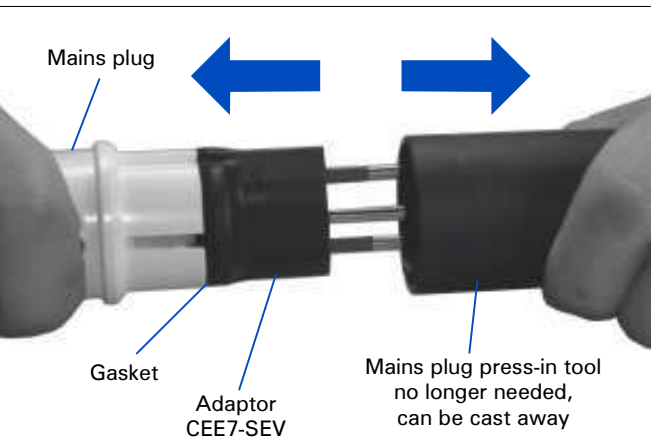

4. Pull the plug out of the connector press-in tool

4. Ziehen Sie den Stecker aus der Einsteckhilfe

4. Retirez la fiche de l'auxiliaire d'enfichage

4. Togliete la spina dall'aiuto inserimento

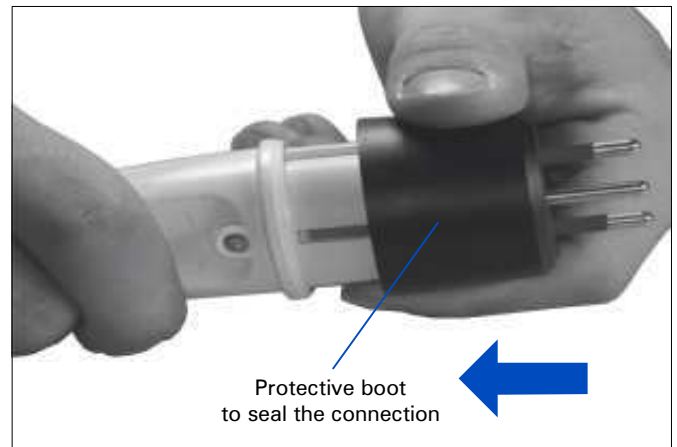

5. Slide protective boot onto adaptor connection until it stops

5. Schieben Sie die Glocke bis zum Anschlag über den Stecker

5. Poussez la cloche de protection contre la butée au-dessus de la fiche

5. Spingete la protezione involucro sopra la spina a fine corda