

**Explosionproof and Dust-tight Fittings and Accessories**

**EXPLOSIONPROOF AND DUST-TIGHT SEALING FITTINGS  
CLASS I, GROUP D;  
CLASS II, GROUPS E, F & G; NEMA 7 & NEMA 9**

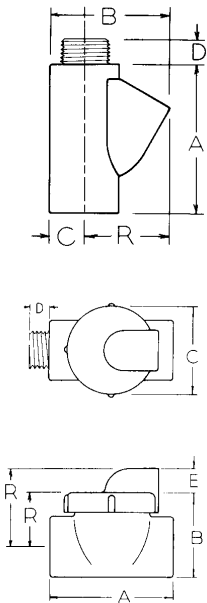

CSA Certified LR27991  
UL Listed E10493

Catalog Number			Dimensions (In.)					R = Turning		
Female/ Female	Male/ Female	Conduit Size	Nominal Dimensions, (In.)					Radius (Inches)		
			A	B	C	D	E	Plain Cover	Sealing Cover	No Cover
XY2	XYM2	1/2	3-1/16	2-7/16	3/4	11/16				1-13/16
XY3	XYM3	3/4	3-1/16	2-7/16	3/4	1				1-13/16
XY4	XYM4	1	3-3/4	2-15/16	15/16	15/16				2-1/8
XY5	XYM5	1-1/4	4-15/16	3-3/16	1-3/16	1-1/8				2-1/8
XY6	XYM6	1-1/2	4-7/8	3-7/16	1-5/16	1-5/16				2-1/4
XYC2	XYC2M	1/2	3-1/16	2-9/16	2-1/6	5/8	13/16	1-7/8	2-11/16	
XYC2S	XYC2SM									
XYC3	XYC3M	3/4	3-1/6	2-9/16	2-1/16	15/16	13/16	1-7/8	2-11/16	
XYC3S	XYC3SM									
XYC4	XYC4M	1	3-11/16	2-11/16	2-3/8	15/16	1	2-1/8	3-1/16	
XYC4	XYC4SM									
XYC5	XYC5M	1-1/4	4-1/2	3-3/16	3-3/8	1-1/16	7/8	2-11/16	3-1/16	
XYC5S	XYC5SM									
XYC6	XYC6M	1-1/2	4-1/2	3-7/16	3-3/8	1-1/8	7/8	2-11/16	3-1/16	
XYC6S	XYC6SM									
XYC8	XYC8M	2	4-11/16	4	3-3/8	1-3/8	7/8	3	3-5/16	
XYC8S	XYC8SM									
XYC10	XYC10M	2-1/2	5-5/16	4-5/8	3-3/8	1-5/8	7/8	3-1/4	3-3/4	
XYC10S	XYC10SM									
XYC12	XYC12M	3	6-7/16	5-7/16	3-15/16	1-3/4	1-3/8	4	4-5/8	
XYC12S	XYC12SM									
XYC14	XYC14M	3-1/2	6-9/16	6-3/8	4-3/4	1-5/8	1-5/16	4-5/8	5	
XYC14S	XYC14SM									
XYC16	XYC16M	4	6-15/16	6-13/16	4-3/4	2	1-5/16	4-3/4	5-3/8	

**ADACO SEALING CEMENT AND ADACO PACKING FIBER  
CLASS I, GROUPS B, C & D; CLASS II,  
GROUPS E, F & G; NEMA 7 & NEMA 9**



XSC

XAF

Catalog No.	Description	Net Weight
XSC-8	ADACO No. 1	8 oz.
XSC-16	Sealing	16 oz.
XSC-160	Cement	10 lbs.
XAF-6	ADACO	1-1/2 oz.
XAF-24	Packing	6 oz.
XAF-64	Fiber	1 lb.

**ADACO SEALING CEMENT** is the easiest-to-use sealing cement on the market. The powder is contained in a polyethylene bag within an outer container. To mix, remove the bag of powder, fill the outside container with water up to the marked "water line" and pour in the powder. Simple...no guesswork about how much water to use. The mixing container is right there...and clean. The largest unit package offered contains one pound of powder. The XSC-160 (10-pound quantity) consists of 10, one-pound packages (at the ten-pound price) so that every mix is correct. This cement has been especially prepared for use in Sealing Fittings. It is not an insulating compound, and is not affected by gasoline, alcohol, benzol, oils, acetone or lacquer solvents.

**ADACO PACKING FIBER** is used with Adaco Sealing Cement for plugging conduit openings in fittings. Alumina Silica based long fiber non-asbestos for use as a packing at the hubs of sealing units to prevent the Sealing Cement in the liquid state from entering the conduit lines. The Fiber is tamped between the wires and the hub before the Sealing Cement is poured into the fitting.