

EXL Explosionproof Exit Sign Factory Sealed

Cl. I, Div. 1 & 2, Groups C, D
Cl. I, Zone 1 IIB
Cl. II, Div. 1, Groups E, F, G

Application:

EXL exit signs are used:

- in locations deemed hazardous due to the presence of flammable vapors or gases, or combustible dusts
- in any building or enclosed area where people work – where illuminated exit signs are required
- to provide distinct, highly visible exit marking
- to indicate the direction of travel to exits

Features:

- Two incandescent lamps (not included) wired in parallel – to provide extra margin of light source reliability
- Solid state circuit for extended lamp life in AC units
- Six inch red letters on white acrylic sign panel make word "exit" stand out boldly and clearly
- Edge lighting characteristic of sign panel makes visibility excellent at all lighting levels
- Factory sealed explosion-proof housing
- Pendant, wall and end bracket mounts provide universal installation options
- Impact-resistant acrylic sign panel needs no guard – makes cleaning easy
- Internal rectifier extends lamp life beyond 1,000-hour rated life – reduces relamping cost
- Relamping tool provided

Standard Materials:

- Body – copper-free aluminum
- Sign panel – acrylic

Conduit Entrance:

- 3/4" hubs

Lamp Wattage:

- Two 60-watt, 60T10 clear lamps for AC units
- Two 25-watt, 25T10 clear lamps for DC units
- Lamps not included with luminaire

Electrical Ratings:

- 120VDC or 120VAC operation.

Certifications and Comiances:

- NEC: Class I, Groups C and D
Class II, Groups E, F, and G
- UL Standard: 844
- NFPA Life Safety Code No. 101-1991

Temperature Performance

Data (for both AC & DC operation):

Ambient Temp (°C)	Class I (C,D)	Class II (E,F,G)	Supply Wire °C
25	T3C	T3C	150°C
40	T3C	T3C	

Ordering Information:

I. When ordering an EXL Series Exit Sign, you will need to specify:

- (A) Voltage (120VAC or 120VDC)
- (B) Mounting (Wall, End Bracket, or Pendant)
- (C) Exit Sign Designation

All units come standard with 3/4" hubs and exit signs with red lettering and white background. Complete catalog numbering is as follows:

EXL (A) 2 (B) (C)

(A) Voltage: 120VAC leave blank
120VDC..... D

(B) Mounting: Wall 1
End Bracket..... 2
Pendant 3

(C) Exit Sign Designation:

- A Single Face (Wall Mount)
- AA Double Face (End Bracket & Pendant)
- AB Double Face, one side arrowhead right, the other no arrowhead (End Bracket & Pendant)
- AC Double Face, one side arrowhead left, the other no arrowheads (End Bracket & Pendant)
- AD Double Face, one side arrowhead both ends, the other no arrowheads (End Bracket & Pendant)
- B Single Face, arrowhead right (Wall Mount)
- BC Double Face, one side arrowhead right, the other arrowhead left (End Bracket & Pendant)
- BD Double Face, one side arrowhead both ends, the other arrowhead right (End Bracket & Pendant)
- C Single Face, arrowhead left (Wall Mount)
- CD Double Face, one side arrowhead both ends, the other arrowhead left (End Bracket & Pendant)
- D Single Face, arrowhead both ends (Wall Mount)
- DD Double Face, both sides arrowhead both ends (End Bracket & Pendant)



Pendant Style



End Bracket Style



Wall Style

Ordering Examples Table:

Mounting Type	Sign Panel Description	Hub Size	AC Cat. #	DC Cat. #
Wall	Single face	3/4	EXL21A	EXLD21A
End bracket	Double face	3/4	EXL22AA	EXLD22AA
Pendant	Double face	3/4	EXL23AA	EXLD23AA

Suffix Options:

Exit Signs with green lettering on white background GN
Unit Provided with Epoxy powder Coat S752
277VAC – (Order ECT413 Transformer Separately)

EXL Explosionproof Exit Sign

**Factory Sealed
Dimensions**

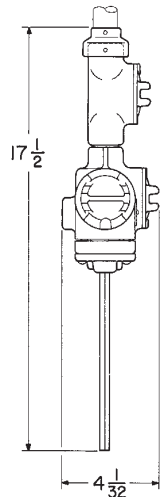

Pendant Style

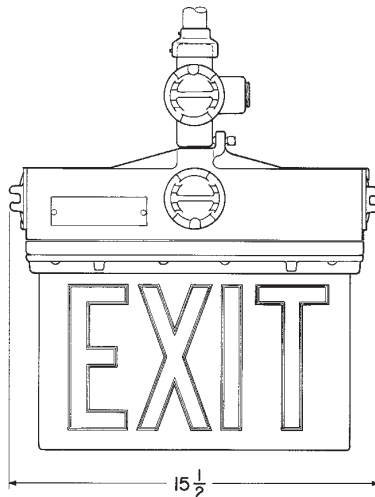

Wall Style

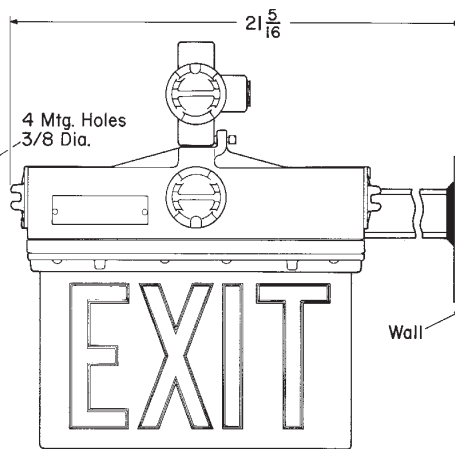
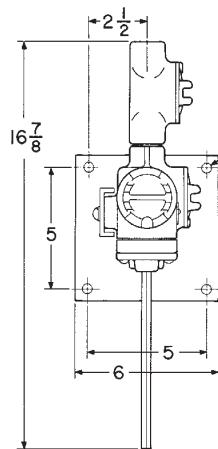
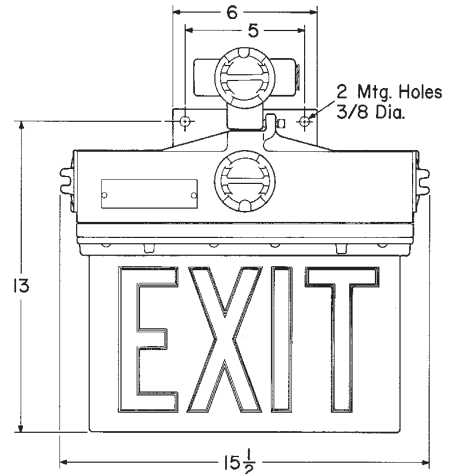
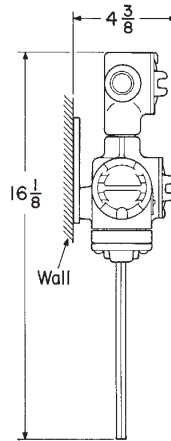

End Bracket Style