

Wiring Devices, Brazil



General Features

- Material: Thermoplastic
- Number of Poles: 2pole+earth, 3-pole
- Contacts: Brass
- Voltage: 250V
- Approvals: NBR 6147 - NEMA1516



Part#	Poles	Current	Voltage	Pin Config.
S-1551 Nema 5-15P	2P + E	15 A	250V	
S-1552 Nema 6-20P	2P + E	20 A	250V	
S-1553 Nema 5-20P	2P + E	20A	250V	
S-1555 Nema 10-20P	3P	20A	125/250V	

Standard-Color: black, for other Colors add Suffix: CZ = grey, VM = red, MF = ivory



Part# (with Cover)	Part# (without Cover)	Poles	Current	Voltage	Pin Config.
S-1666	S-1656	2P + E	10/15A	125/250V	
S-1661 Nema 5-15R	S-1651 Nema 5-15R	2P + E	15A	250V	
S-1665 Nema 10-20R	S-1655 Nema 10-20R	3P	20A	125/250V	
S-1662 Nema 6-20R	S-1652 Nema 6-20R	2P + E	20A	250V	
S-1663 Nema 5-20R	S-1653 Nema 5-20R	2P + E	20A	250V	

Standard-Color: black, for other Colors add Suffix: CZ = grey, VM = red, MF = ivory



Part#	Poles	Current	Voltage	Pin Config.
S-1657/M (Metal Clips)	2P + E	10/15A	125/250V	
S-1657/PL (Plastic Clips)	2P + E	10/15A	125/250V	
S-1671/M (Metal Clips)	2P + E	15A	125V	

Standard-Color: black, for other Colors add Suffix: CZ = grey, VM = red, MF = ivory



Part#	Poles	Current	Voltage	Pin Config.
S-2057 (Fast-On)	2P + E	10/15A	125/250V	
S-2058 (Wire Leads 1,5 mm ²)	2P + E	10/15A	125/250V	
S-2058/25 (Wire Leads 2,5 mm ²)	2P + E	10/15A	125/250V	

Standard-Color: grey, for other Colors add Suffix: PT = black, VM = red, MF = ivory



Part#	Poles	Current	Voltage	Pin Config.
S-2157 (Fast-On)	2P + E	10/15A	125/250V	
S-2158 (Wire Leads 1,5 mm ²)	2P + E	10/15A	125/250V	
S-2158/25 (Wire Leads 2,5 mm ²)	2P + E	10/15A	125/250V	

Standard-Color: grey, for other Colors add Suffix: PT = black, VM = red, MF = ivory



Part#	Dimensions	Hole-Diameter
S-1660	(115.0x71.5x7.0)mm	35mm

Standard-Color: grey, for other Colors add Suffix: PT = black

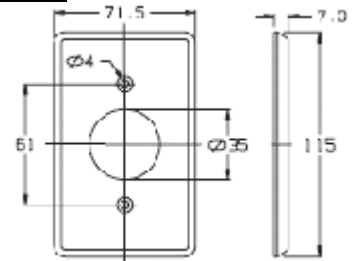

Types S-1651, S-1652, S-1553, S-1555

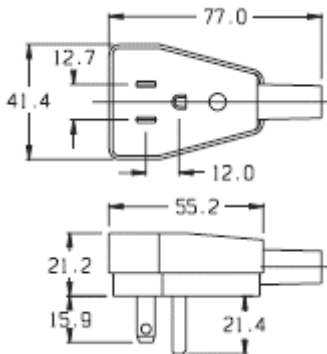

Types S-2057, S-2058

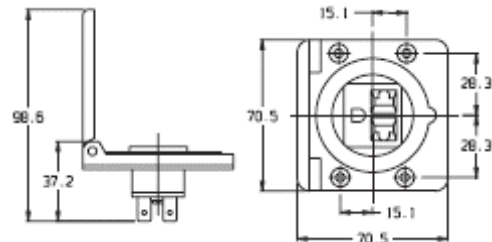

Types S-1657, S-1658, S-1671

